

Grovit[®] For Blind Hole Applications

Designed for blind hole applications in wood, plastics, fibre-glass and aluminium. Can also be used in harder substrates.



Key features and benefits

- Annular grooves on the body expand radially during installation
- Provide a vibration resistant joint and increased pull-out resistance

Specifications

Sizes:

2.4 mm to 4.8 mm
(3/32" to 3/16")

Materials:

Zinc plated Steel and
Aluminium Alloy

Head Style:

Dome, Countersunk

Typical placing sequence

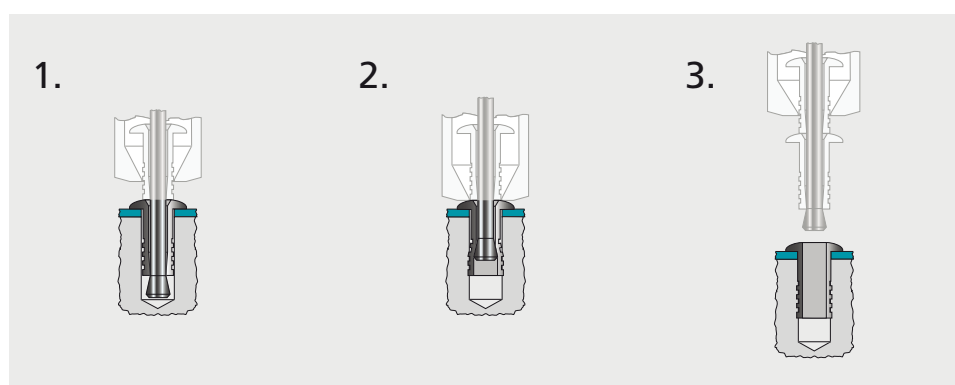

Please visit our website www.StanleyEngineeredFastening.com for fastener placing animations.

Assembly applications

- Automotive
- Domestic appliances
- Electrical equipment
- Injection moulded components

Grovit[®] fastener in timber



Trouser press



Trouser press (detail)



PVC connector block in air conditioning unit



Grovit[®] fastener used as a quick connect low pressure bleed hose



PVC strip connector



Installation Systems

From cost-effective power tools to custom assembly systems, Speed Fastening® equipment offers rapid and reliable assembly to meet your specific requirements. The equipment is an integral part of the Speed Fastening System and offers the following benefits:

- High speed, reliable fastener feed
- Assembly cycle times within two seconds
- Single side assembly
- Simple operation
- Quick reload
- Low maintenance costs
- Ideal for low volume batch work through to fully automated assembly lines

Power Tools

For low volume production up to 500,000 fastener p.a.

Power tools



753 Standard tool



7537 Power tool



Workstations

For medium volume production from 250,000 up to 1,000,000 fastener p.a.

Workstations



7535 Pantograph workstation



Mini-MAS



Assembly Workstations

For high volume production > 1,000,000 fastener p.a.

Bespoke systems



Twin head fixed pitch workstation

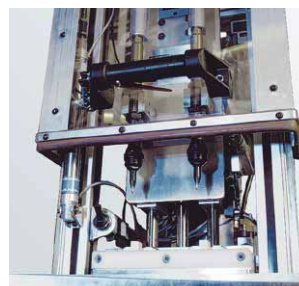

23 placing heads to assemble a computer chassis





English	Français	Deutsch	Italiano	Español
Dome head	Tête plate	Flachrundkopf	Testa tonda	Cabeza alomada
Low carbon steel*	Acier bas carbone*	Stahl*	Acciaio a basso tenore di carbonio*	Acero bajo en carbono*
Zinc plated	Revêtement zingué	Verzinkt	Zincato	Zincado
Clear trivalent passivated	Passivation claire trivalente	Klar chromatiert, Cr6-frei	Passivazione chiara trivalente	Pasivado claro trivalente

*: SAE 1008 / EN 10263-2 C8C DIN 10263-2 C8C Qst 34-3

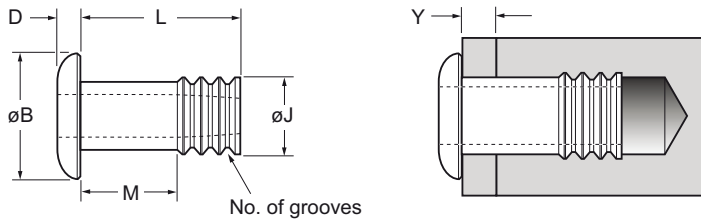

ø	Y	No. of grooves		øB	D	L	øJ	M	No. of grooves / cannelures / Rillen / rigature / aros	kN ¹⁾	Fasteners per pod / Nombre de rivets par chargeur / Niete pro Magazin / Rivetti per caricatore / Uds./carga	Part No/ref
		min.	max.									
3.2 (1/8")	3.6	3.45	3.55	5.6	1.0	8.8	3.43	3.2	3	1.20	± 1	01101-00410
4.0 (5/32")	2.8	4.40	4.50	6.6	1.3	7.2	4.37	1.6	3	2.20	36	01101-00508
	4.4					10.4		3.2	4		25	01101-00512
	5.2					11.9		4.8	4		22	01101-00514
4.8 (3/16")	3.2	5.08	5.18	9.0	1.7	8.0	5.05	2.4	3	3.50	31	01101-00609
	7.2					15.9		8.8	4		17	01101-00619

all dimensions in mm / en millimètres / alle Maße in mm / in millimetri / en milímetros

1) typical values / valeurs moyennes / typische Werte / Valori tipici / valores típicos